

EASTERN LABS

Instructions Model RM-1205 04/25/2007

Operation

**Junction Box
Assembly**

**Different Types of
Switch Installations**

**Counter Mounting
Suggestions**

Operation

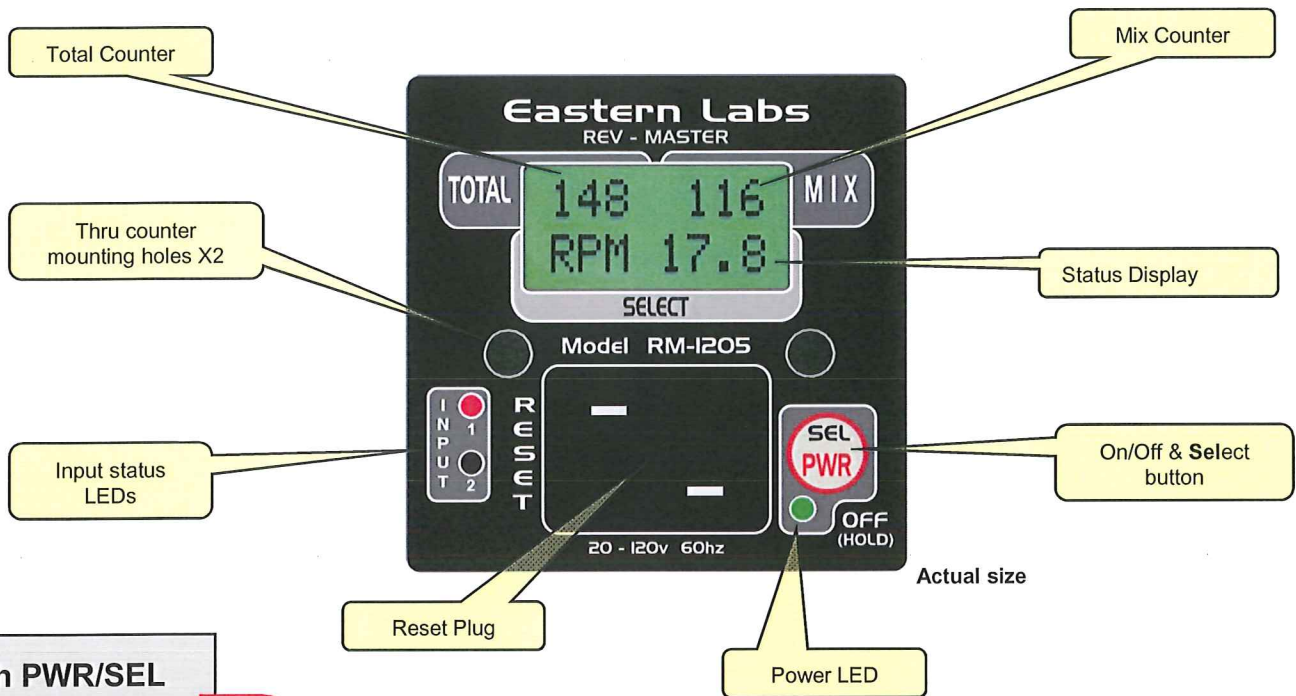

Push PWR/SEL button to turn on

LOCKOUT
RESET

Normal power up display.
(Plug in reset cord)

REMOVE
RESET

Displayed while resetting.
(Unplug reset cord)

Normal Operating Mode

000 000
RPM 0.00

RPM display will momentarily flash
one of the drum status displays.

By pushing the PWR/SEL button the RPM
display cycles thru these displays.

Note: In operating mode Total and Mix counters are
always displayed. Only the lower half changes

Shut Down
In 3

PWR/SEL button held more than
1.5s, shut down count will start.
When zero is reached the unit
will power off. If released before
zero, the unit returns to where it
left off in operating mode.

Agitate

Mixing

Charging

Discharg

Display's backlight
flashes on & off

TIM 0:26

Time since reset
H:MM

PS 6-18

Mixing range Preset
Lo cutoff - Hi cutoff

TPR 3.41

Time per Revolution
Seconds

LSA 0.13

Limit Switch actuation time
Seconds

Back to RPM

Junction Box Assembly

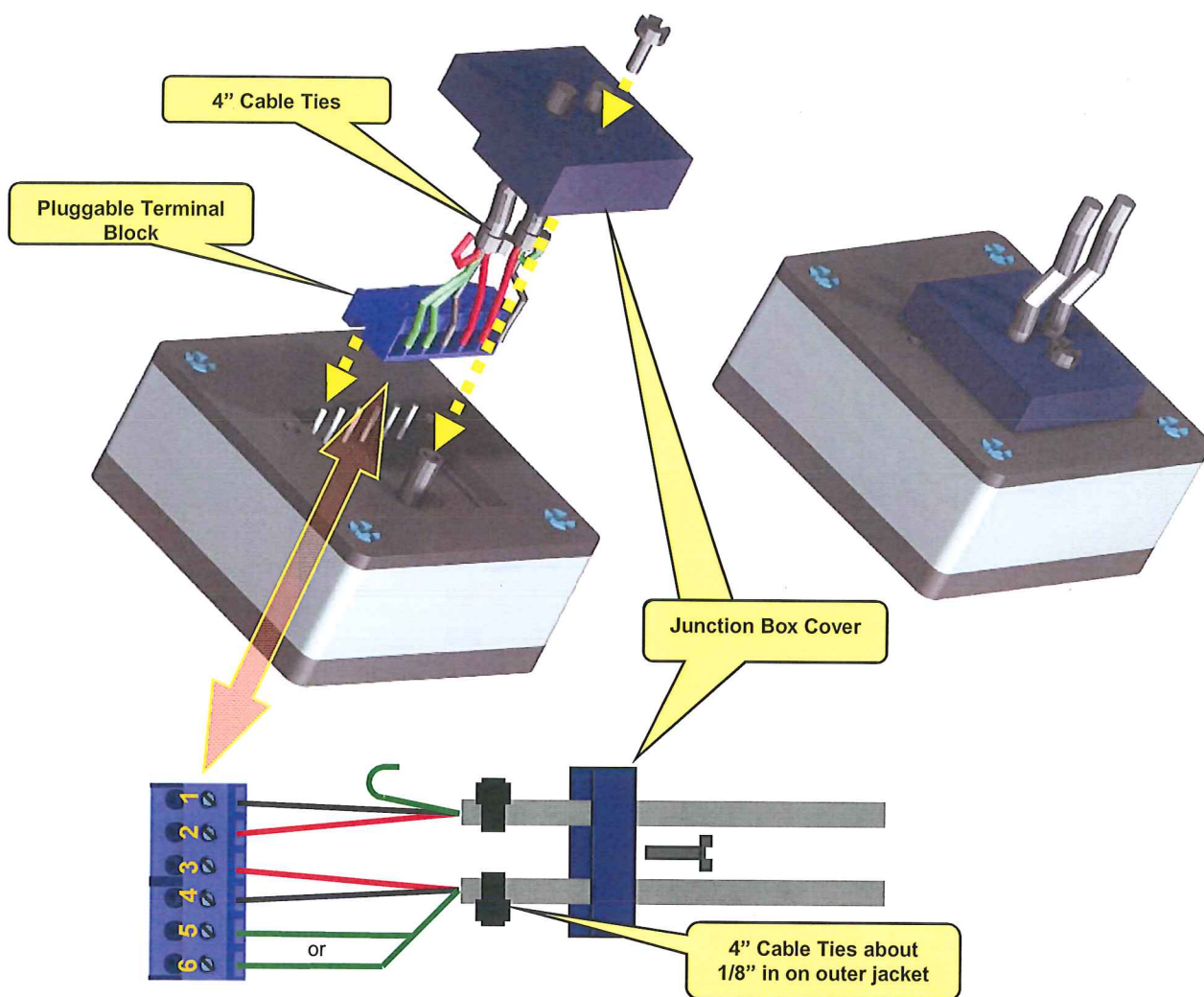

Terminal Block Pin Assignments

Power In

- 1.....-12v power in (ground)
- 2....+12v power in (hot after ignition sw.)

To Sensor Switch

- 3.....+12v power out to switch (fused)
- 4.....-12v power out to switch (ground)
- 5.....Input 2 for double pulse inputs (Eastern's Prox. or Standard Prox. with fork arm)
- 6.....Input 1 for single pulse inputs (Limit Switch or Standard Prox. with bar arm)

Note: For those with dual sensors
Use input 1 & 2 where 1 is on
before 2 in mixing direction

Prewired for
Limit Switch
from factory

Use this page only for
Standard Limit Switch
Installation

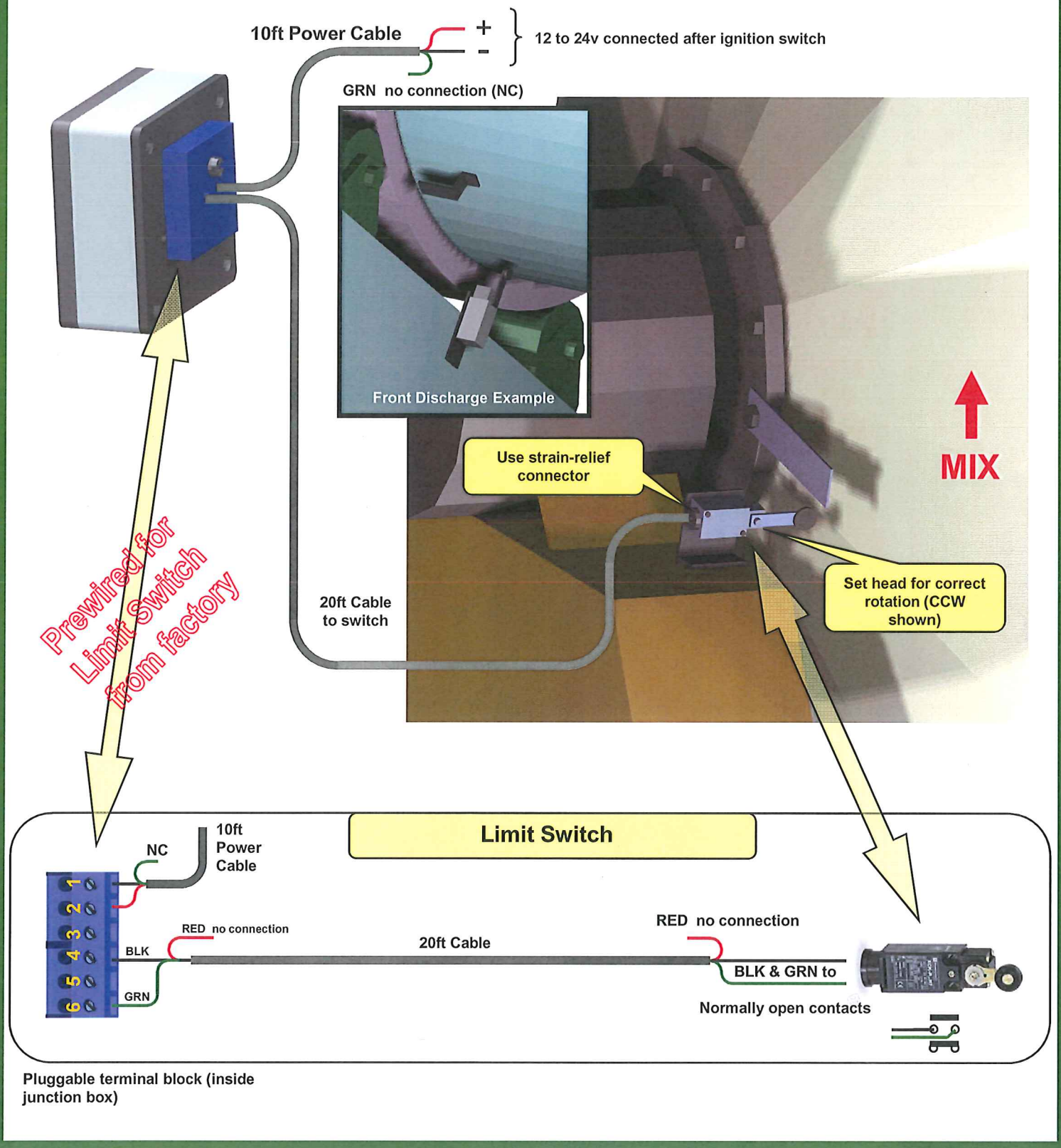

Use this page only for
DP-0306F Proximity Switch
Installation

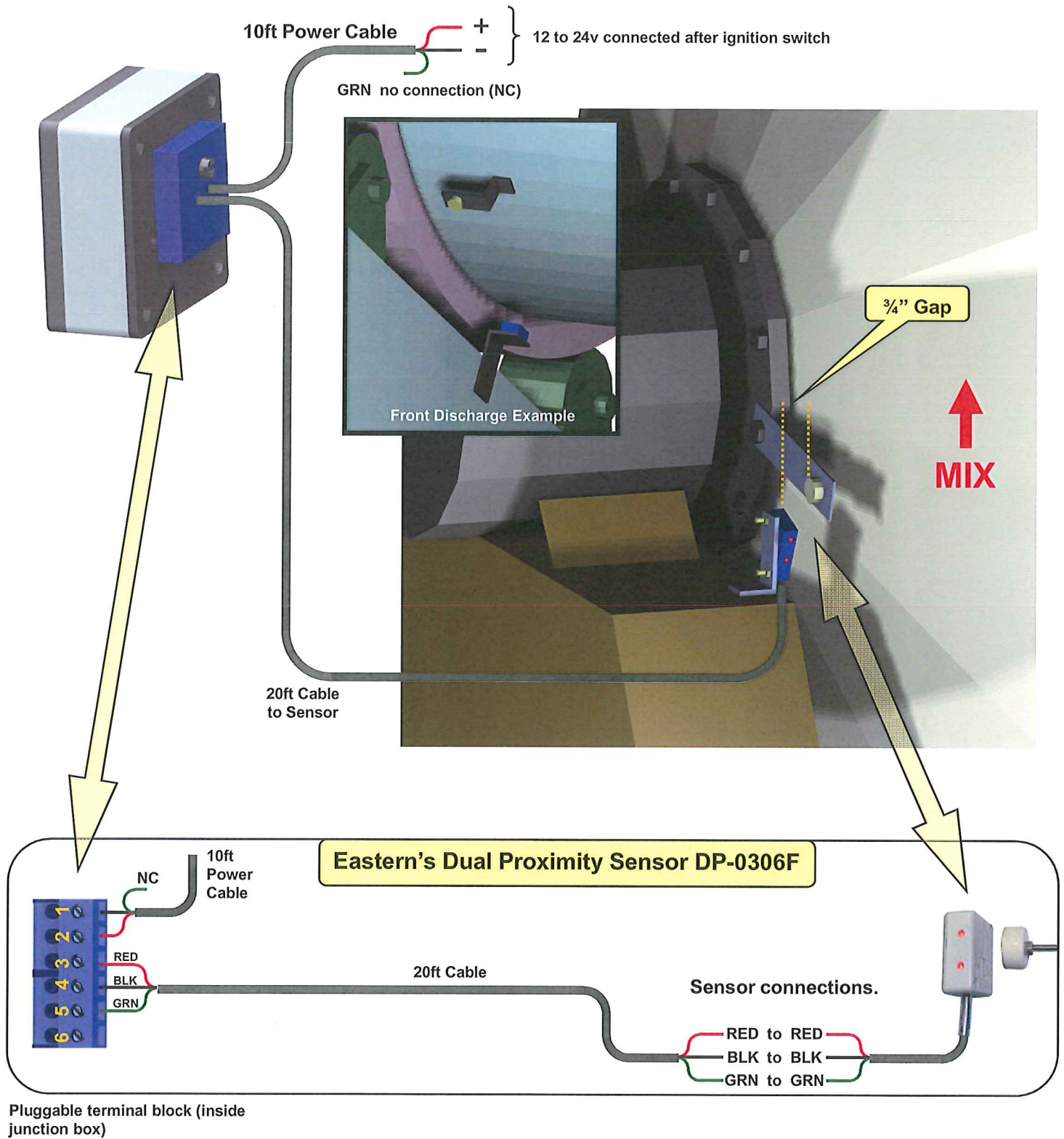

Use this page only for
Standard Proximity Switch
Installation
Using a Fork Arm

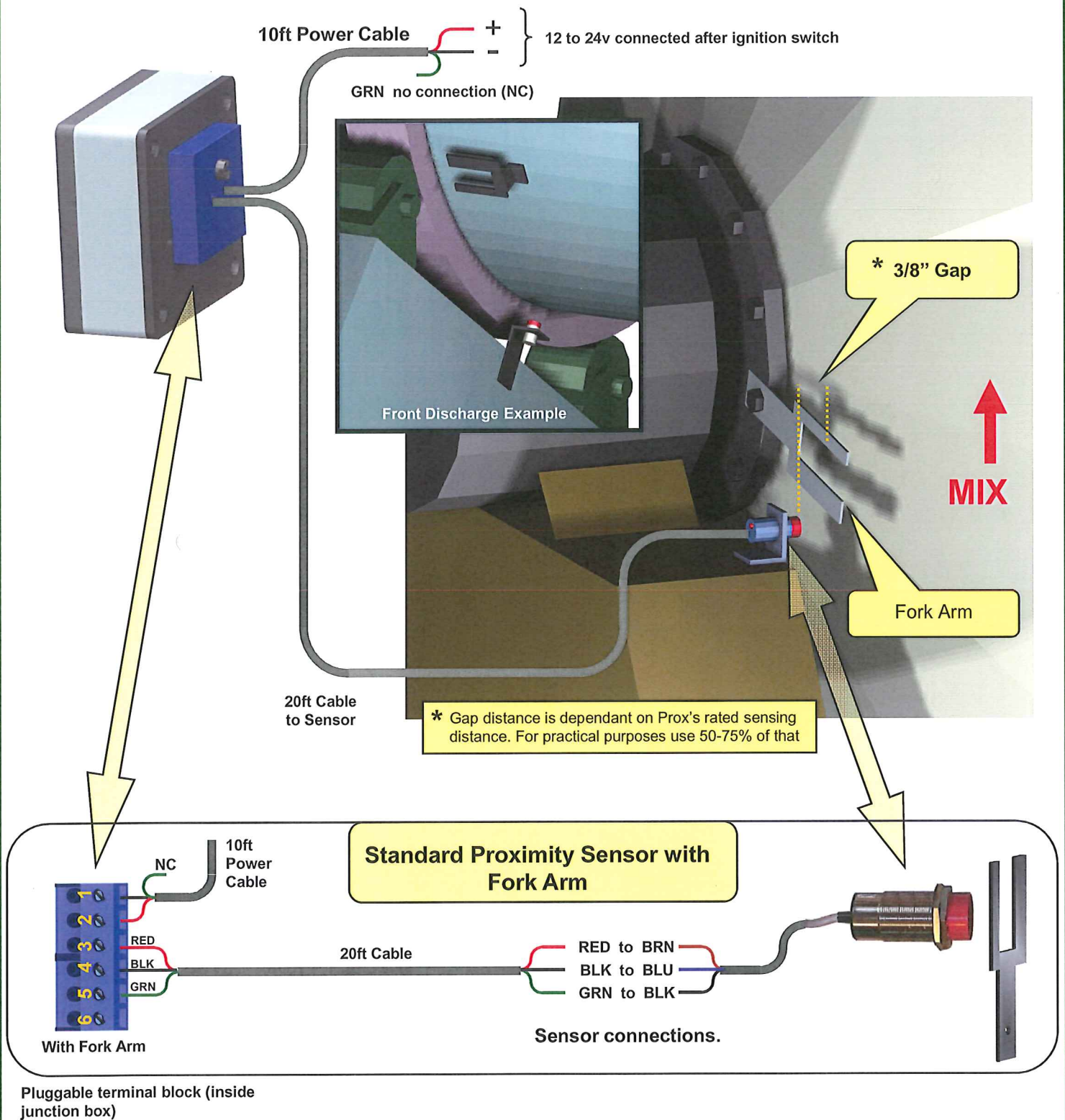

Use this page only for
Standard Proximity Switch
Installation
 Using a Bar Arm

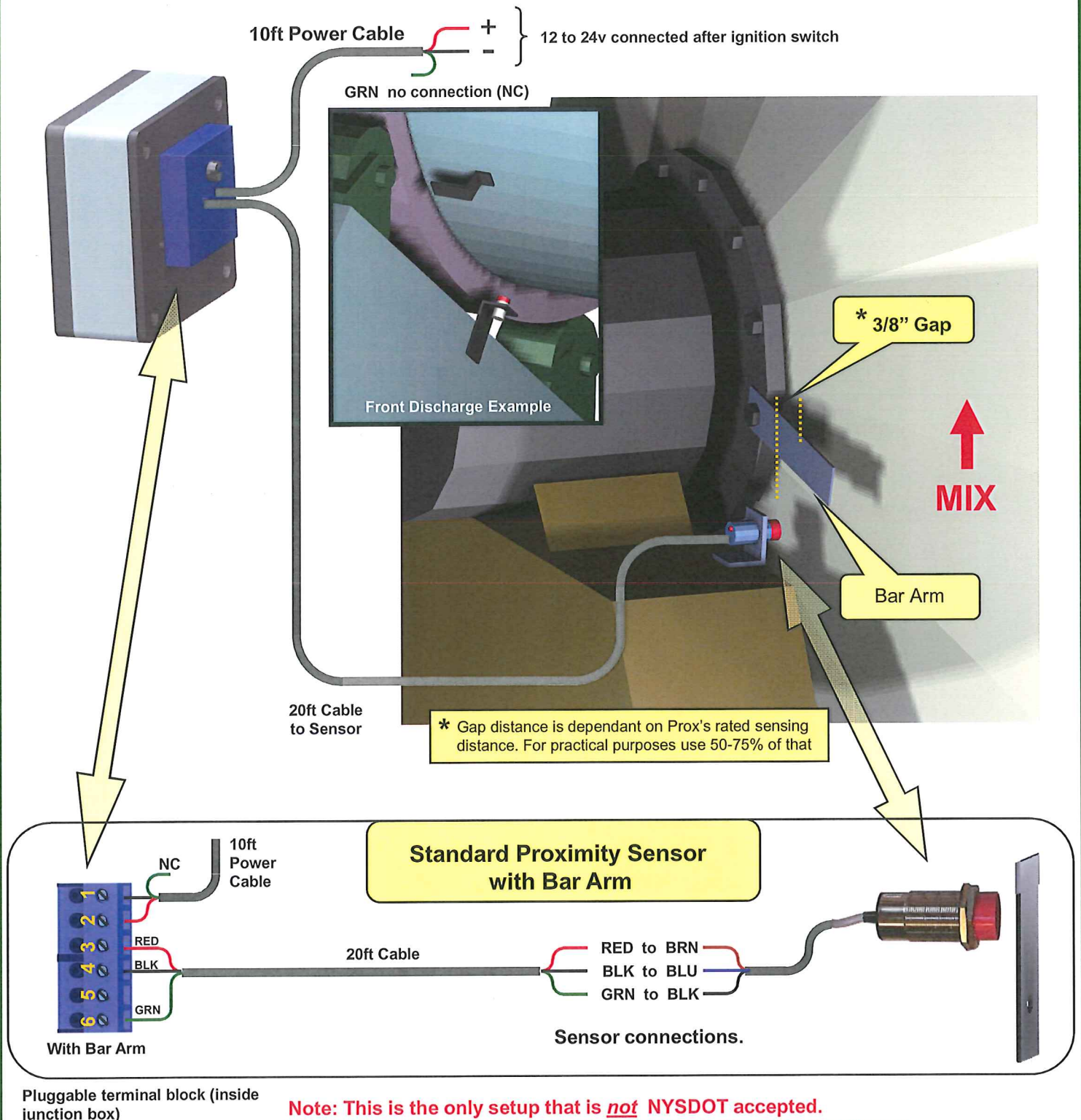

Note: This is the only setup that is not NYSDOT accepted.
This is for use in areas where counting in both directions is allowed.

Instrument Panel Mounting Flush Mount



Cut a 2-3/8" square hole in dash. Take counter apart and reassemble with the face in front of the dash and the rest (aluminum ring, back plate, terminal block, & junction box cover) from behind the dash.

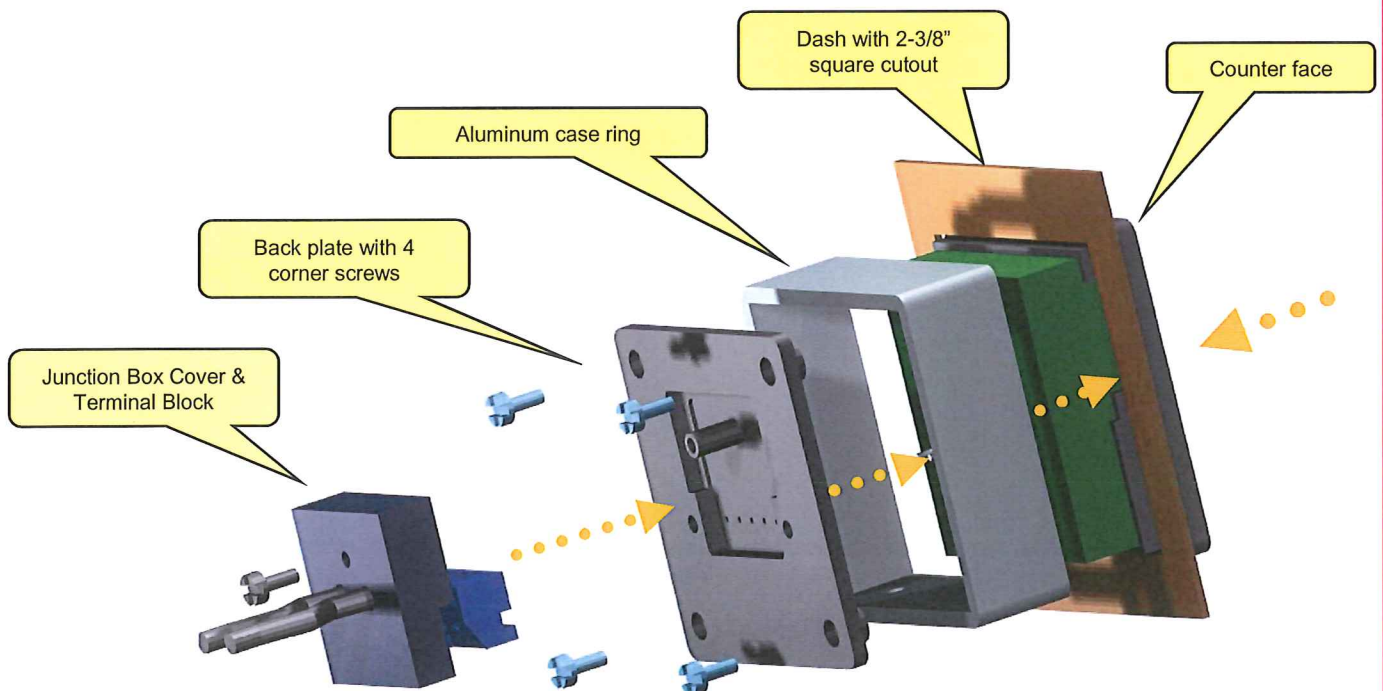

Instrument Panel Mounting 2" Gauge Hole

Make the connections and run the cables thru desired 2" gauge hole

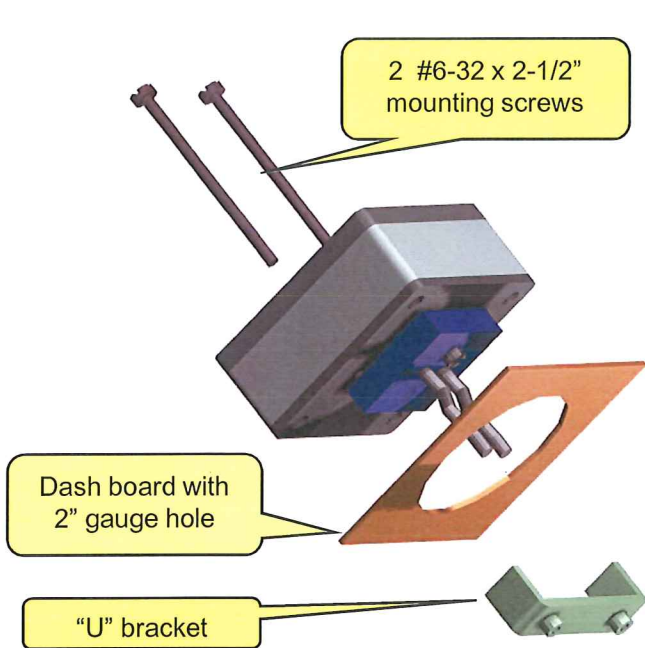

NEXT

Put counter head in dash and screw the 2 #6 screws into "U" bracket

OR

Put the 2 #6 screws thru counter head and just start them into "U" bracket. Tilt and shift the head & "U" bracket into the gauge hole.

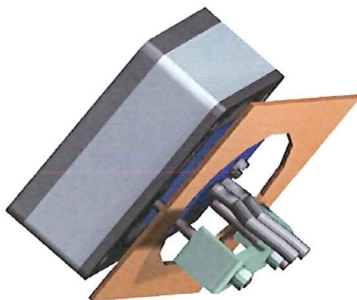

NEXT

Center the head in the hole and tighten down the screws

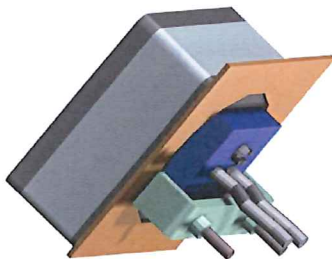

To remove the head in the future just remove 1 #6 screw completely and loosen the other. This will allow you room to tilt and shift the head & "U" bracket out.

Side Mounting

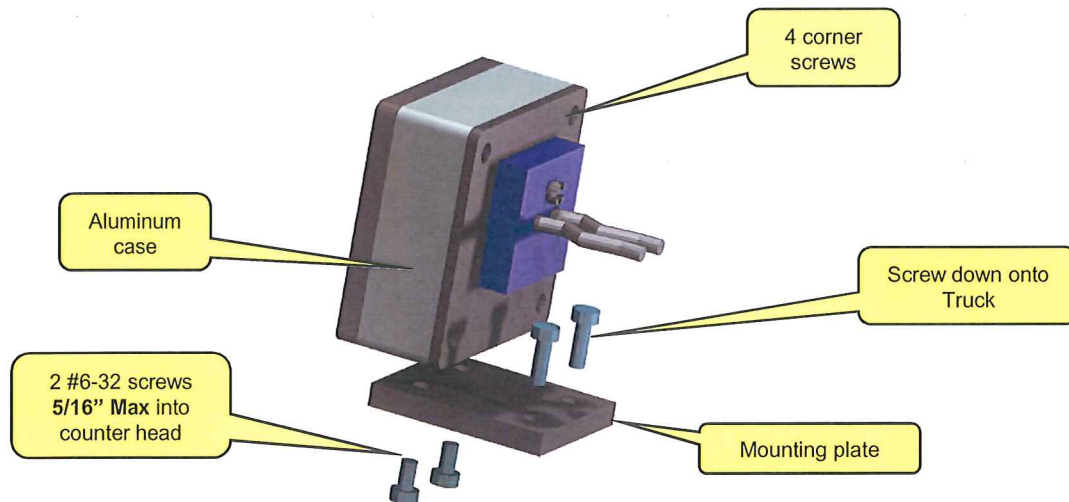

Caution: Only use #6-32 x 5/16" screws that go into counter head. Using longer screws can cause damage internally.

Changing the mounting side

Mounting plate can be put on any of the 4 sides. To change this remove jack box and unplug terminal block (refer to: Junction Box Assembly page). Remove 4 corner screws and pull off back plate. Slide out aluminum ring and rotate so that the mounting holes are on the desired side. Reverse to reassemble.

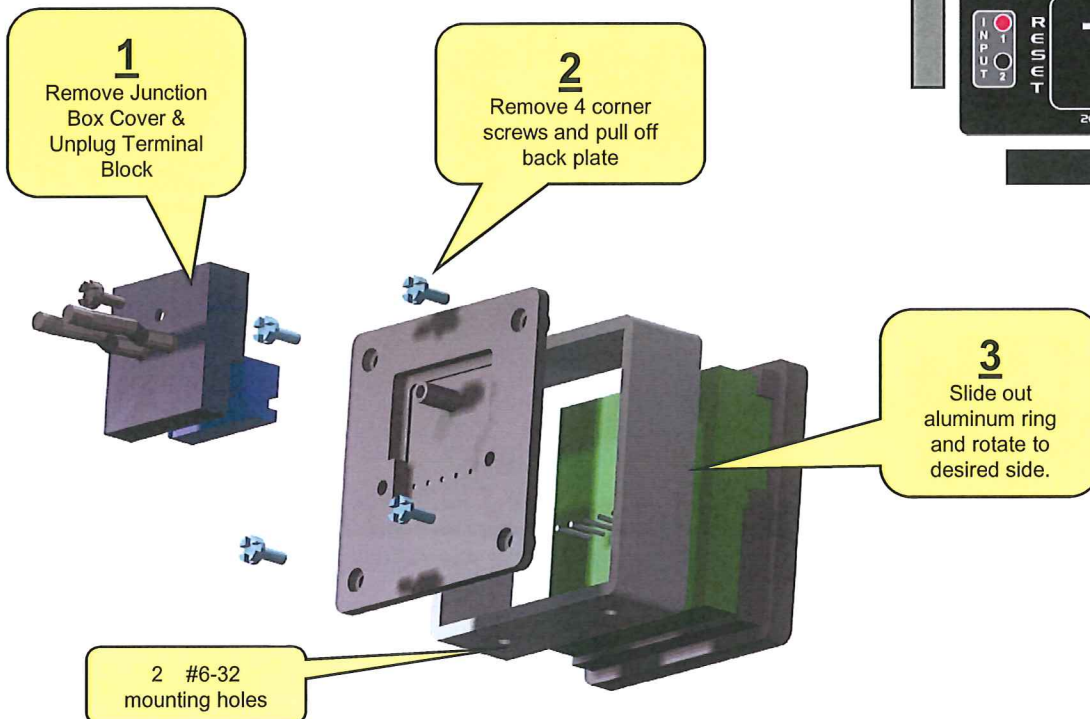

Additional Mounting Ideas

Surface Mounting

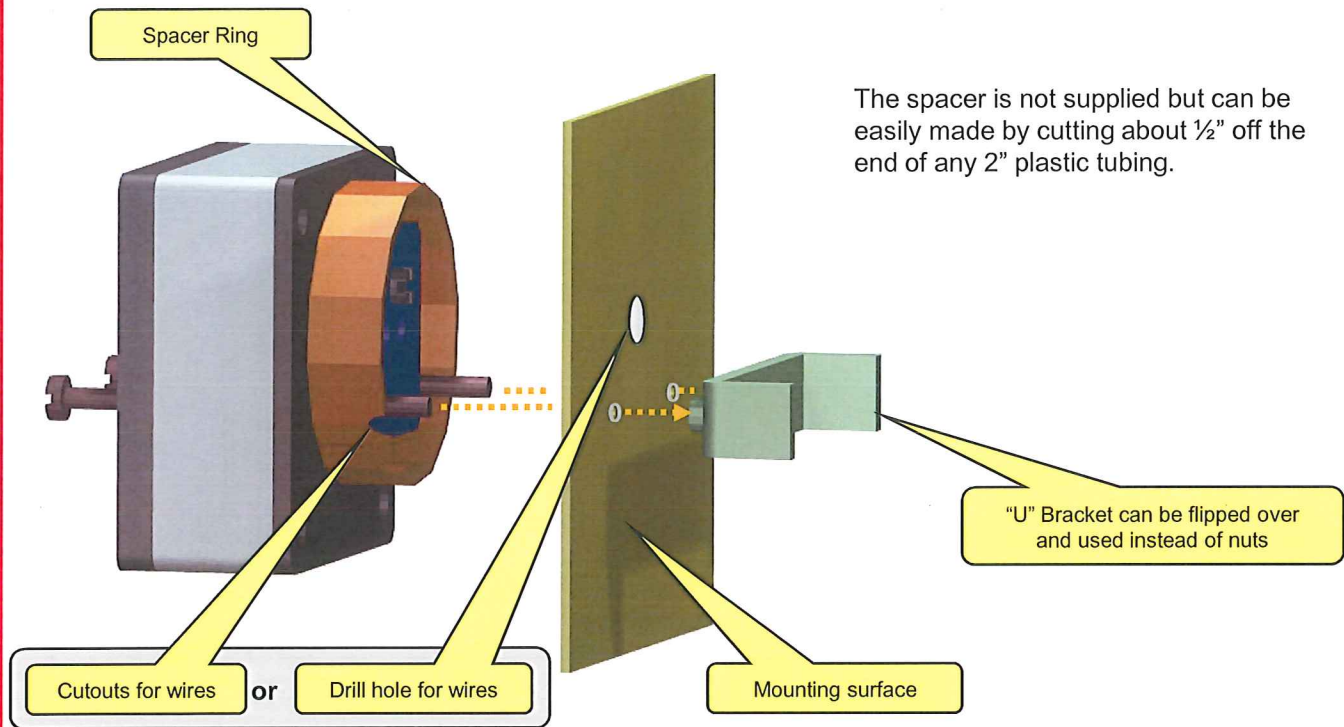

Gauge Bracket Mounting

